



MASON INDUSTRIES, Inc.
Manufacturers of Vibration Control Products

350 Rabro Drive 2101 W. Crescent Ave., Suite D
Hauppauge, NY 11788 Anaheim, CA 92801
631/348-0282 714/535-2727
FAX 631/348-0279 FAX 714/535-5738
Info@Mason-Ind.com Info@MasonAnaheim.com

CERTIFIED FOR

JOB NAME :
CUSTOMER :
CUSTOMER P.O. :
MASON M.I. :
DWG. NO. :

TYPE

SAB

Certified Seismic
Anchor Bolt
with Washer

**ALL PARTS
ELECTROPLATED**

"CS" CAP SCREW
WITH STANDARD
WASHER

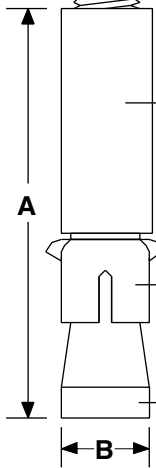
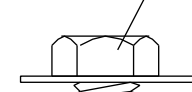

SEISMIC ANCHOR
(Internally Threaded)

EXPANSION
WEDGE

PULL THROUGH
RESISTANT
SHOULDER

TYPE SAB ANCHOR BOLT RATINGS installed into 3000 psi (20 Mpa) concrete

Size	Minimum Anchor Embedment (in) (mm)	Minimum Edge Distance (in) (mm)	Minimum Anchor Spacing (in) (mm)	Concrete Type			
				Stone Aggregate		Lightweight	
				Tension* (lbs) (kg)†	Shear (lbs) (kg)†	Tension* (lbs) (kg)†	Shear (lbs) (kg)†
SAB-3/8	2 5/8 67	5 1/4 133	7 7/8 200	720 327	1050 476	575 261	840 382
SAB-1/2	3 1/2 89	7 178	10 1/2 267	1010 458	1830 830	800 363	1500 680
SAB-5/8	4 3/8 111	8 3/4 222	13 1/8 333	2220 1007	2970 1347	1625 737	2720 1234
SAB-3/4	5 1/4 133	10 1/2 267	15 3/4 400	2330 1057	3340 1515	— —	— —
SAB-1	5 3/4 146	11 1/2 292	17 1/4 438	3660 1524	6610 2998	— —	— —

*These tension values are applicable when the anchors are installed without special inspection as set forth in Section 1701.1 of UBC. When anchors are installed with special inspection as set forth in Section 1701.1 of the UBC, the tabulated values may be increased by 100%.

†For kN divide kg by 102

Notes:

The tabulated values are for anchors installed at the specified spacings and edge distance. Spacings may be reduced by 67% provided the tension values are reduced to 50% (65% for SAB-1) and the shear values are reduced by 60%. Edge distances may be reduced by 50% provided the tension values are reduced by 30% and the shear values are reduced by 50%. Linear interpolation may be used for intermediate spacings.

For combined tension and shear forces on anchors, use the following equations:
 $(P_s/P_t)^{5/3} + (V_s/V_t)^{5/3} \leq 1.0$, where: P_s and V_s are Applied Forces
and P_t and V_t are Allowable Forces

Ratings may be increased 33 1/3 % to accommodate periodic forces such as wind or seismic loads. Tabulated values include a safety factor of 8 to 1 for tension forces and 4 to 1 for shear forces.

For Stone Aggregate Concrete, refer to ICBO Report #ER-5063.
For Lightweight Concrete, refer to Techmar report #TR-1193.

TYPE SAB ANCHOR BOLT DIMENSIONS

Size	A		B		CS	
	(in)	(mm)	(in)	(mm)	(in)	(mm)
SAB-3/8	2 5/16	67	1/2	13	3/8"-16 UNC x 1 1/4	3/8"-16 UNC x 32
SAB-1/2	3 1/16	89	5/8	16	1/2"-13 UNC x 1 1/2	1/2"-13 UNC x 38
SAB-5/8	3 13/16	111	7/8	22	5/8"-11 UNC x 1 3/4	5/8"-11 UNC x 44
SAB-3/4	4 5/8	133	1	25	3/4"-10 UNC x 2 1/4	3/4"-10 UNC x 57
SAB-1	5	146	1 1/4	32	1"- 8 UNC x 2 1/2	1"- 8 UNC x 64

CERTIFICATION DATA

DWN : CHKD : DATE :

DWG NO. :